

DESCRIPTION AND INSTRUCTIONS FOR THE LINK HANGER

THE LINK HANGER HAS BEEN DESIGNED TO PROVIDE A SECURE HANGING FOR ARTWORKS IN THE WEIGHT RANGE BETWEEN 20 AND 100KGS OR THAT HAVE A REBATED FRAME; THESE INCLUDE LARGE GILT FRAMES OR GLAZED WORKS.

A SET WILL HANG ONE ARTWORK AND CONSISTS OF 4 X PLATES AND 2 X LINKS.

INFO

Discreet. The Link Hanger is fixed behind the work with no projections.

Secure. The Link Hanger uses a system that usually requires two people who are knowledgeable of the system in order to remove the work.

Adjustable. The Link Hanger has been designed to allow quick and easy adjustment of the artwork to achieve the desired level, greatly aiding gallery layouts and hangings.

Approved. The Link Hanger has been approved by the Museum and Galleries Commission and is in use by many major institutions: The Tate Gallery and the Royal Academy of Arts are two notable examples.

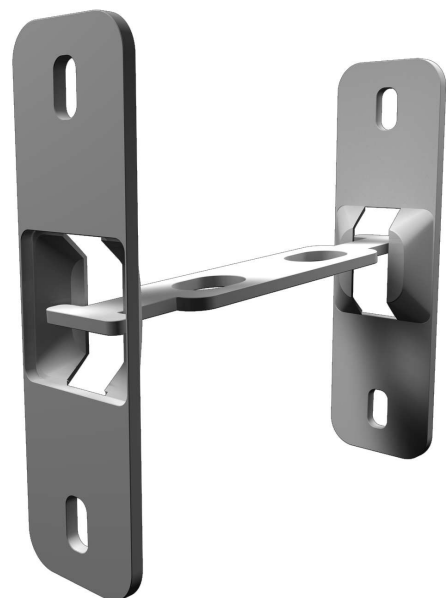

DESCRIPTION AND INSTRUCTIONS FOR THE LINK HANGER

- 1 Installation:**

Screw two of the Link plates in a vertical position to the rear of the chosen artwork approximately a quarter of the way down the side frames when measured from the top. The plates should be well in from the edge and you should use 3.5mm diameter (No:8) dome or panhead screws in the centre of each slot (This allows for adjustment later). Then measure the distance from centre to centre of the two Link plates. this will be distance X.
- 2** Fix the two remaining Link plates to the wall surface in a vertical position at the same distance apart as on the artwork.. distance X. It is worth noting that the plates on the wall should be slightly higher than the plates on the artwork.. this will be dependant on the depth of the rebate.
- 3** Next step is for one or two assistants (dependent upon the size of the work) to hold the artwork in position so that the plates on the artwork and wall are opposite each other while another member of staff places the links in position.. This is done by fitting both plates whilst in a vertical plane and then rotating them through ninety degrees. Slowly lower the artwork when secure until the fixings take the weight. Assess whether the artwork is hanging level and if necessary remove it, loosen the screws fixing the Link plates to the artwork and adjust up or down to achieve the desired position before retightening the screws.

The Link Hanger will hang works up to 100kgs in weight.